



6024 NR Deep groove ball bearings

- SKF Explorer

Deep groove ball bearings

Bearing data

[Tolerances](#),

Normal (metric), P6, P5, Normal (inch),

[Radial internal clearance](#),

Matched bearing pairs, Stainless steel
 $d < 10$ mm, Other bearings

Bearing interfaces

[Seat tolerances for standard conditions](#),

[Tolerances and resultant fits](#)

Technical specification

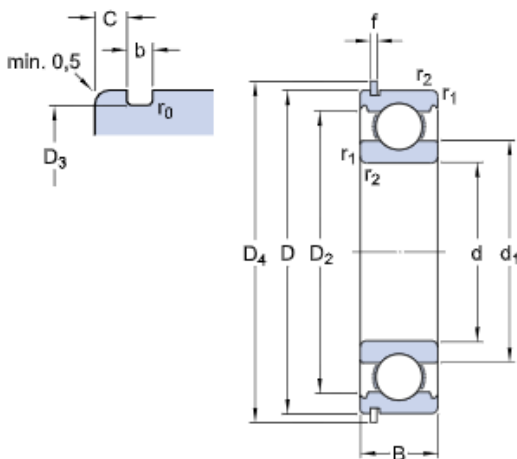

DIMENSIONS

d	120 mm	Bore diameter
D	180 mm	Outside diameter
B	28 mm	Width
d_1	≈ 139.05 mm	Shoulder diameter
D_2	≈ 165.3 mm	Recess diameter
D_3	173.66 mm	Diameter of snap ring groove
D_4	192.9 mm	Outside diameter of snap ring
b	3.5 mm	Width of snap ring groove
C	3.71 mm	Distance outer ring from side face to snap ring groove
f	3.1 mm	Width of snap ring
r_0	max. 0.6 mm	Bottom radius of snap ring groove
$r_{1,2}$	min. 2 mm	Chamfer dimension

ABUTMENT DIMENSIONS

d_a	min. 129 mm	Diameter of shaft abutment
D_a	max. 171 mm	Diameter of housing abutment
D_b	min. 195 mm	Diameter of snap ring recess in the housing

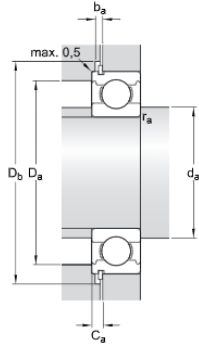

b_a	min. 4 mm	Width of snap ring recess in the housing
C_a	max. 6.81 mm	Distance from outer ring side face to snap ring back face
r_a	max. 2 mm	Radius of shaft or housing fillet

CALCULATION DATA

C	88.4 kN	Basic dynamic load rating
C_0	80 kN	Basic static load rating
P_u	2.75 kN	Fatigue load limit
	7 500 r/min	Reference speed
	4 800 r/min	Limiting speed
k_r	0.025	Minimum load factor
f_0	16	Calculation factor

MASS

	2.19 kg	Mass bearing
--	---------	--------------

INCLUDED PRODUCTS

SP 180	Snap ring
--------	-----------

TOLERANCE CLASS

P6	Dimensional tolerances
Normal	Radial run-out